

DEPARTMENT 17 - FLOWERS

SUPERINTENDENT: Pam Hult 419-545-4319
ASST. SUPERINTENDENT: Mary Ellen Lawrentz

RULES:

1. Open to all Richland County amateur growers and arrangers.
2. Exhibitors are required to have an Exhibitor's ticket that provides them with an Exhibitor's number and may be purchased at the Fair Board office for \$40.00 & includes 7 admittances to the fair. Juniors do not need to purchase an Exhibitor's ticket unless they are entering the adult division, but must have an Exhibitor's number that is provided when entries are made.
3. **Entry tags must be picked up at the Fair Board Office. DO NOT CHANGE TAGS, GO TO OFFICE FOR NEW TAGS IF NEEDED. CHANGED TAGS WILL BE DISQUALIFIED.**
4. All entries must be passed by the Entries committee before placing in show.
5. Assistance will be provided to bring entries from the EAST gate to the Arts & Crafts Building Monday and Thursday. Contact the superintendent if you need this service.
6. Entries not claimed will be moved at owners risk.
7. Exhibits will be eliminated from competition if they are not in the proper class, are not properly registered or fail to meet the requirements of the schedule. The Flower show committee will sub divide classes if entries warrant it. Judges decision is final.
8. All entries must be removed Sunday after fair between 8:00am and 11:00 am.
9. Persons removing entries early will forfeit premium money.
10. Richland County Fair is not responsible for damages or losses during display period.



Basic Design Quick Reference Guide

↑ Line material: foliage or flower spikes
Round Form Flowers ○ ● ● ● ●

L-shape

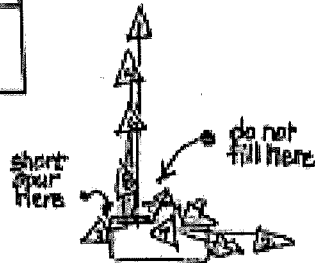

Step 1 is centered at 12 o'clock position. Step 2 is placed at 4 o'clock position. Each successive line is placed to the outside of the previous one — lower and along the arc.

Crescent

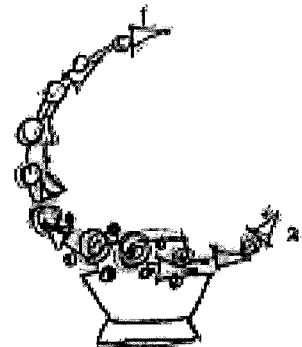

Inverted-T

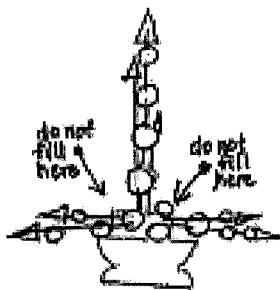

Vertical

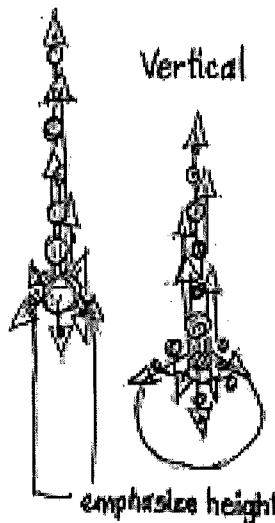

Hogarth Curve

the tip of the first line is placed over container's center; tip of next line is placed to outside of the first, but is shorter. at bottom, tip of first line is centered lining up with the top tip.

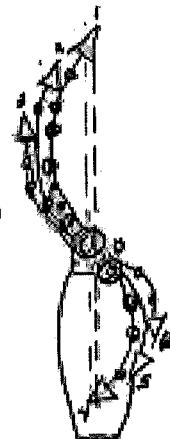

Diagonal



an overall diamond shape is formed of two triangles base-to-base.

Horizontal

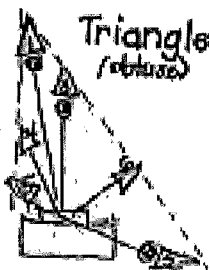

Triangle (obtuse)

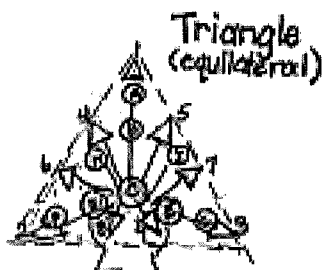

Triangle (equilateral)

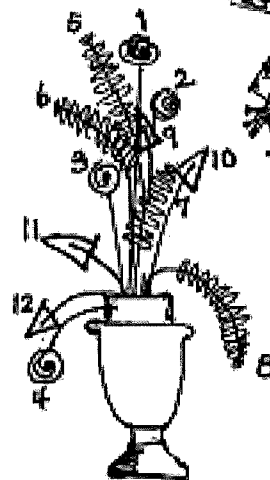

Mound

one Mass plan starts with four steps: first flower straight up, second one shorter and to the side of first, third shorter and right of the first; fourth low, to the front, cascading. The triangulation continues with other materials until placements become less vertical.

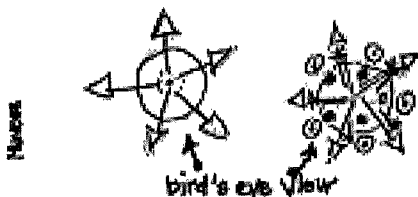

bird's eye view

DEPARTMENT 17 - FLOWERS

SPECIMEN CLASSES

SECTION 1 FIRST SHOW First show exhibits accepted Sunday 5 pm to 8 pm & Monday 8 am to 9:30 am.
Open Judging Monday @ 10 am.
Remove Wednesday 8 pm to 9 pm.

Exhibits should be groomed and free of soil or spray residue.

Specimen flower should be disbudded where noted and shown with natural foliage. (Disbudding is removing bud shoots as the specimen develops). Some clear glass bottles will be available, however you should plan to provide your own. Bottles must be suitable for size of exhibit. Styrofoam will be available for wedges.

Specimen must be grown by the Exhibitor and correctly labeled as to variety. More than one entry per class is allowed, provided each entry is a different variety.

CLASSES: PREMIUMS: 3.50 2.50 2.00 BEST OF SHOW/ROSETTE

1. Rose, long stem Red, 1 bloom, disbudded
2. Rose, long stem Yellow
3. Rose, long stem Pink
4. Rose, Floribunda, 1 cluster
5. Rose, Miniature, 1 bloom
6. **BEST OF SHOW ROSE CATEGORY**
7. Tuberos Begonia with leaf unattached, float in water
8. Gladiolus in bloom, 1 spike with one leaf, disbudded of dead flowers
9. Hibiscus Bloom
10. Hydrangea, Lace Variety, 1 cluster
11. Hydrangea, Cluster Mound Variety
12. **BEST OF SHOW HYDRANGAEA CATEGORY**
13. Snapdragon, 1 spike
14. Rudbeckia, 1 bloom, disbudded (Gloriosa Daisy, Goldstrum, Indian Summer, etc.)
15. Daylily, 1 stem. Flower blooms only one day
16. Zinnia, (4" or over) 1 boom, disbudded
17. Zinnia, Small flowered,(1 1/2" to 3"), 3 blooms of same variety, disbudded with one set of leaves
18. Marigold, Large flowered, 1 bloom, disbudded
19. Marigold, petite, 1 spray-(multiple flowers on one stem)
20. Spider Plant, 1 spike-(keep seed pod whiskers on)
21. Celosia, plumed, 1 stem, no side stems
22. Celosia, crested, 1 stem
23. Dahlia, 1 variety, 3 blooms, 3"and under, disbudded, same color size, stem length with leaves
24. Dahlia, 1 bloom, over 3", disbudded with one set of leaves
25. Petunia, Single bloom, 1 spray
26. Petunia, Double petals bloom, 1 spray

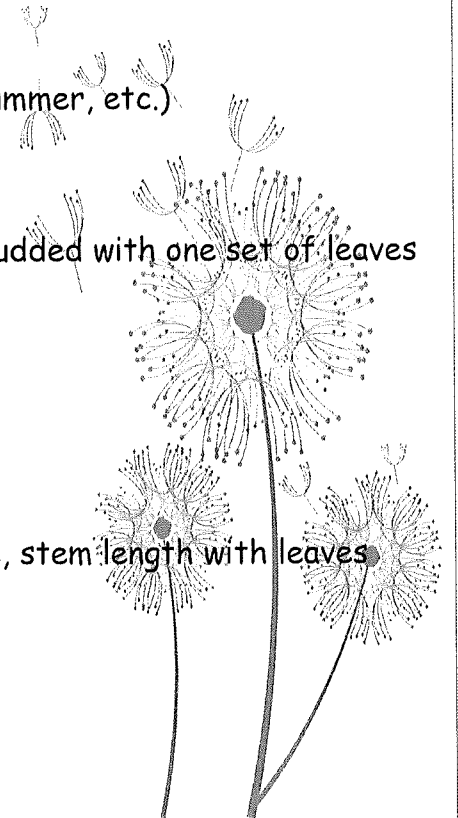

DEPARTMENT 17 FLOWERS

SECTION 1 FIRST SHOW contd. SPECIMAN CLASSES

27. Sunflower, small decorative, 1 bloom, disbudded not to exceed 8" in diameter
28. Bulb, 1 stem (magic lily, calla lily, or oriental lily)-(these blooms last several days)
29. Any other round form, 1 bloom, disbudded-A variety that is not listed in another class-(like daisy, aster, etc.)
30. Any other spike form, 1 stem-A variety not listed in another class-(a single stalk like flower)
31. Any other spray form, 1 spray-A variety not listed in another class-(a spray has a single stem with blooms on lateral branches-(like phlox, geranium, status, lantana)
32. Everlasting, fresh, 3 blooms or 1 spray, variety
33. Caladium, 1 leaf
34. Coleus, 1 stem-(pinch off flower spike bloom)
35. Echinacea (Ex. Purple Cone flower), 1 bloom, disbudded
36. Any other perennial round form, 1 bloom, disbudded
37. Any other perennial spike form, 1 stem
38. Any other perennial, spray form, 1 spray
39. Lisanthus - one stem with open flower & buds
40. Flowering shrub, not over 24"
41. Fruited shrub, not over 24"
42. Vine, not over 24"
43. Ground Cover, 1 stem, named
44. Hosta, one leaf, named
45. Hosta, "collection" of 5 leaves, named - each in its own vial or vase-all same height
46. Herb, perennial, named, one stem only
47. Herb, annual, named-one stem only
48. Collection of herbs, 5 varieties, named - each Herb in its own vial or vase-all same height
49. Cosmo, 3 stems, same color, stem height in one vase
50. Calendula, 3 stems, same color, stem height in one vase
- 51. BEST OF SHOW ONLY NAMED SPECIMENS MAY QUALIFY FOR BEST OF SHOW AWARD.**

DEPARTMENT 17 FLOWERS

SPECIMEN CLASSES

SECTION 2 **SECOND SHOW** Second show exhibits accepted Thursday 8 am. to 9:30 am.
Open Judging Thursday @ 10 am.
Removal Sunday after the fair @ 8 am to 11 am.

CLASSES: *same classes as in SECTION 1*

Exhibits should be groomed and free of soil or spray residue.
Specimen flower should be disbudded where noted and shown with natural foliage.

(Disbudding is removing bud shoots as the specimen develops).

Some clear glass bottles will be available, however you should plan to provide your own. **Bottles must be suitable for size of exhibit.** Styrofoam will be available for wedges.

Specimen must be grown by the Exhibitor and correctly labeled as to variety.
More than one entry per class is allowed, provided each entry is a different variety.



SECTION 3

To be entered in first show & left for ENTIRE FAIR

Must be in exhibitors possession at least 90 days

Arrive Sunday 5 pm. to 8 pm. or Monday 8 am. To 9:30 am.

Open Judging Monday @ 10 am.

Removal Sunday after the fair @ 8 am. to 11 am.

Plants must have specimen name on entry tag

PREMIUMS: \$3.50 \$2.50 \$2.00 **BEST OF SHOW/ROSETTE**

DEPARTMENT 17 FLOWERS

SECTION 3

CLASSES:

1. Foliage plant, 1 plant per pot not to exceed 24"
2. Blooming plant, 1 plant per pot not to exceed 24"
3. Foliage hanging plant, 1 variety must provide hanger
4. Blooming hanging plant, 1 to 3 variety must provide hanger
5. Combination planting, to include 3 -5 varieties, named (basket/decorative pot may be used) not to exceed 36"
6. Cacti or succulent, not to exceed 24"
7. Geranium, 1 plant per pot not to exceed 24"
8. Fairy Garden, not to exceed 24"
9. **BEST OF SHOW**

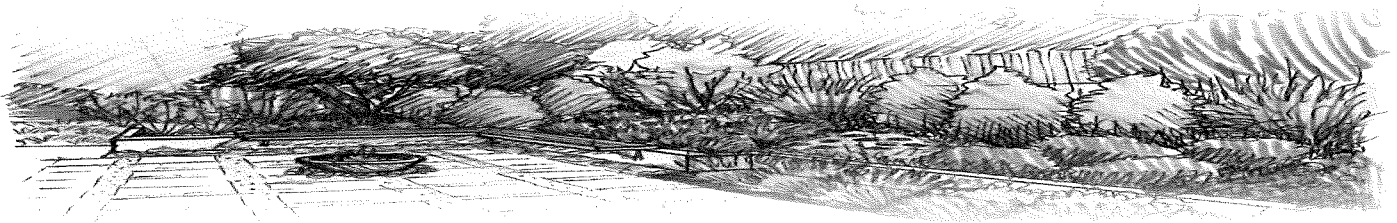

SECTION 4

LANDSCAPING AND DESIGN

RULES: **PREMIUMS:** \$50.00 \$25.00 \$15.00 **BEST OF SHOW/ROSETTE**

1. Theme & Title of your choice. Not to exceed 10' depth by 8' wide.
2. May use Business sign, Club name in display.
3. May use water fountain, lights, artificial grass, live & natural materials.
4. May refresh as needed during the week of fair (August 4th thru August 10th)
5. Set up on Saturday prior to start of fair 8 am. to 4 pm.
6. Removal Sunday after the fair @ 8 am. to 11 am.

CLASSES:

1. LANDSCAPE & DESIGN for Businesses, Limited to first 3 entries.
2. LANDSCAPE & DESIGN for Garden Club Groups. Limited to first 3 entries.

DEPARTMENT 17 FLOWERS

SECTION 5 FIRST SHOW

ARRANGEMENT CLASSES

RULES: PREMIUMS \$5.00 \$4.00 \$3.00 BEST OF SHOW/ROSETTE

1. **SECTION 5**—Entries arrive on Sunday 5 pm. to 8 pm. or Monday 8 am. to 9:30 am.
2. Open Judging Monday @ 10 am.
3. Removal of **SECTION 5** entries on Wednesday 8 pm. To 9 pm.
4. One entry per person per class for each show.
5. Accessories are permitted in all classes unless otherwise stated.
6. No artificial plant material may be used.
7. Painted material permitted in classes. Do not cut fruits or vegetables.
8. Limited space will be provided for assembly of arrangements in **workroom**.
9. Exhibitors **must** check in with the placement committee before staging arrangements.
10. The committee is not responsible for breakage, theft or loss of property.
11. **A TRADITIONAL ARRANGEMENT** is the type you would put on your table as a center piece, mostly garden flowers bouquet.
12. **A CREATIVE ARRANGEMENT** is larger, with use of bold colors, few rules and no set pattern - use of medal, rope, wood with fewer flowers, like you would see at a fancy event not you typical bouquet.
13. **ALL PLANT & FLORAL MATERIAL MUST BE IDENTIFIED ON 4X4 INDEX CARD, EXPLAIN YOUR ARRANGEMENT INTERPRETATION ALONG SIDE OF DISPLAY**

SECTION 5 FIRST SHOW

ARRANGEMENT CLASSES

THEME: 150TH KENTUCKY DERBY

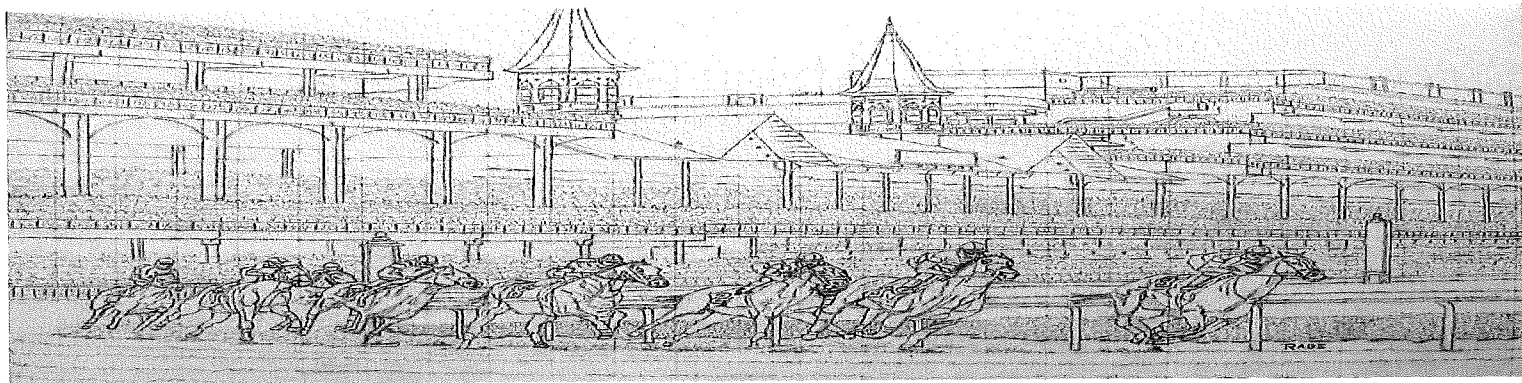

Classes for first show:

1. **The Run for the Roses:** A traditional triangle design with use of red flowers.
2. **Triple Crown:** A creative vertical parallel group of three arrangements in one container. Yellow or gold flowers. May use a crown.
3. **My Old Kentucky Home:** A creative design that incorporates old wood, etc. and white flowers.
4. **Celebrations:** A traditional moss design with use of multi colored flowers.
5. **Derby Hats:** A traditional mound design using a pretty/fancy Derby Hat as your container. Designers choice of colors.
6. **BEST OF SHOW** (in 1st show Mon. thru Wed.)

DEPARTMENT 17 FLOWERS

SECTION 6 SECOND SHOW

Arrives on Thursday

Classes for second show:

1. **The Run for the Roses:** A creative design. Designers own interpretation with use of Red flowers.
2. **Mint Jubilee:** A traditional design. Official drink of the Kentucky Derby. Arrangement in a goblet shaped container with all green foilage and flowers.
3. **Boot Scootin Boogie:** A traditional design arrangement in a Cowboy Boot with your Choice of colors.
4. **Horses Hats & Happiness:** A creative design of one's own interpretation. May use rope, metal etc. with flowers, your choice of colors.
5. **Place Your Bets:** A traditional design with designers own choice of shape. Yellow or gold flowers.
6. **BEST OF SHOW (in 2nd show Thurs. Thru Sat.)**



SECTION 7

NICHES

THEME: WINE and DINE

RULES:

1. To be entered in the first show & left for the entire fair May refresh on Thursday, if needed.
2. Limit to FIRST 4 ENTRIES. Must reserve space with superintendent.
3. Entries arrive on Sunday 5 pm. to 8 pm. Or Monday 8 am. to 9:30 am.
4. Open judging on Monday @ 10 am.
5. Removal Sunday after the fair 8 am. to 11 am.
6. All plant and floral material must be identified on 4x4 index card along side display.

CLASS: PREMIUMS \$5.00 \$4.00 \$3.00 BEST OF SHOW /ROSETTE

1. **Traditional or creative, floral design of your choice with matching table setting (for 1 person)**
2. **BEST OF SHOW**



DEPARTMENT 17 FLOWERS

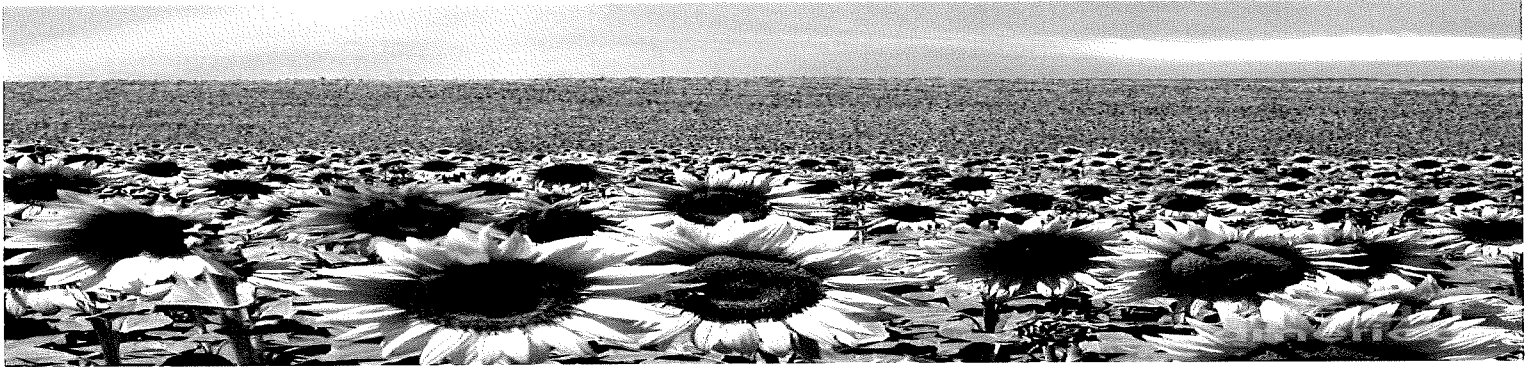

SECTION 8 SUNFLOWERS

RULES:

1. Entries arrive on Sunday 5 pm. to 8 pm. or Monday 8 am to 9:30 am. And stays for the entire fair.
2. Open Judging Monday @ 10 am.
3. Removal Sunday after the fair 8 am. to 11 am.

CLASS: **PREMIUMS:** \$5.00 \$4.00 \$3.00 **BEST OF SHOW/ROSETTE**

1. Tallest (Bring in a 5 gallon bucket with dirt to cover its roots.)
2. Largest Head
3. **BEST OF SHOW**

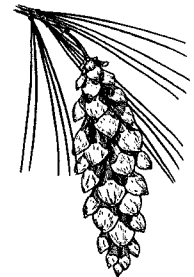
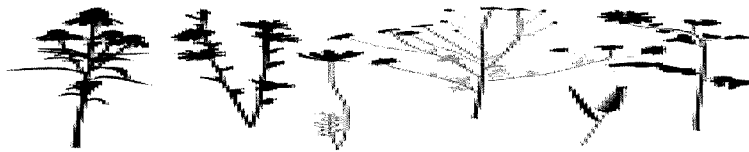
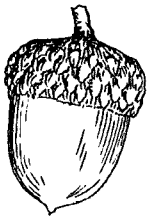

SECTION 9 CRAFTED ITEMS

RULES:

1. Entries arrive on Sunday 5pm. to 8 pm. or Monday 8 am. to 9:30 am.
2. Open judging on Monday @ 10 am.
3. Removal Sunday after the fair 8 am. to 11 am.
4. Designs must incorporate pods, cones, nuts, dried flower, etc.

CLASSES: **PREMIUMS:** \$2.50 \$2.00 \$1.50 **BEST OF SHOW/ROSETTE**

1. Christmas Ornament
2. Door Hanging not to exceed 24"
3. Dried design in a 5 x 7 frame
4. **BEST OF SHOW**

DEPARTMENT 17 FLOWERS

SECTION 10

JUNIORS

RULES:

1. Entries arrive on Sunday 5 pm. to 8 pm. or Monday 8 am. to 9:30 am.
2. Open judging on Monday @ 10 am.
3. Removal Sunday after the fair 8 am. to 11 am.
4. No entry fee needed to enter Junior section. **MUST HAVE EXHIBITOR'S NUMBER.**
5. Age must be stated on both entry form & entry tag.

CLASS A (5 thru 10 YEARS OLD)

CLASS B (11 thru 18 YEARS OLD)

CLASSES: PREMIUMS: \$3.00 \$2.50 \$2.00 BEST OF SHOW/ROSETTE

1. Horticulture Specimen spike form: A spike flower: a single stalk, flowers at the bottom, bloom first-(Like: Snapdragon, Lupine, Foxglove etc.)
2. Horticulture Specimen round form: A round shaped flower: single stem with a few leaves-(Like: Daisy, Zinnia, Dahlia etc.)
3. Horticulture Specimen spray form: A single main stem, blooms on tiny branches from main stem-(Like: Phlox, Geranium, Lantana, Status, etc.)
4. Horticulture Specimen herb collection 3 varieties, named: each herb, one stem in its own vial or vase all the same height.
5. Bean Mosaic design on a 5"x7" CARDBOARD. Cover design with thick coat of white glue.
6. Fairy Garden not to exceed 24" in diameter.
7. Sunshine on Your Shoulders Floral arrangement with use of a Sunhat as your container with plastic type of liner. Your choice of flower colors.
8. Theme: Kentucky Derby: Mud Pie, Make in 9 x 13 tin pan. Use mud as your base, add your choice of flowers and items, etc.
9. **BEST OF SHOW** **CLASS A**
10. **BEST OF SHOW** **CLASS B**

ENTRY FORM FOR DEPARTMENTS 12-13-14-15-16-17-18

ENTRY TAGS MUST BE OBTAINED FROM THE FAIR OFFICE SATURDAY BEFORE FROM 12 PM. THRU 5 PM. BEFORE ADMITTANCE TO DEPARTMENTS.

OPEN CLASS

DEPARTMENTS 12 THRU 18

DEADLINE IS JULY 28TH

ENTRIES MUST BE COMPLETELY FILLED OUT & LEGIBLE

RICHLAND COUNTY FAIR
750 North Home Rd., Mansfield 44906
Phone 419-747-3717
MAIL-IN ENTRIES WILL BE SEASON
PASSES ONLY

EXHIBITOR
NAME _____

ADDRESS _____

CITY _____ STATE - OHIO ZIPCODE _____

PHONE # _____ AGE: _____

As of January 1st



	DEPT.	SECT.	CLASS		DEPT.	SECT.	CLASS
1				19			
2				20			
3				21			
4				22			
5				23			
6				24			
7				25			
8				26			
9				27			
10				28			
11				29			
12				30			
13				31			
14				32			
15				33			
16				34			
17				35			
18				36			

	DEPT.	SECT.	CLASS		DEPT.	SECT.	CLASS
37				63			
38				64			
39				65			
40				66			
41				67			
42				68			
43				69			
44				70			
45				71			
46				72			
47				73			
48				74			
49				75			
50				76			
51				77			
52				78			
53				79			
54				80			
55				81			
56				82			
57				83			
58				84			
59				85			
60				86			
61				87			
62				88			

All entries must either purchase a season pass or membership pass.

All mail-in entries will be season passes only.

For office use only

Total Entry Fees \$ _____

Membership Fee \$ _____ # _____ X \$40.00

(Richland County residents only-gives voting rights/7passes-must be 18 or older)

Season Pass \$ _____ # _____ X \$40.00 (All entries must purchase either a season or membership pass/7passes)

Total Fees \$ _____ Check # _____ (Payable to RCAS) CASH

RECEIPT # _____ DATE _____ 2024

The Richland County Fair Board will take every precaution in its power for the preservation of livestock, livestock articles and still projects on exhibition, after their arrival and arrangement on the grounds, but is hereby agreed and understood by the undersigned owner/exhibitor that all livestock, livestock articles and still projects are brought onto the fairgrounds at the owner's/exhibitors risk. The Richland County Agriculture Society, its employees, officers, director's and agents will not be held liable nor responsible for any damage to livestock, livestock articles, still projects by fire, water, disease, windstorm and act of God, or any other cause, whatever its nature. Nor will the Society be held liable for any loss by thefts or accidents to person or property, nor for any errors or omissions in the Premium Book. I have read and understand this and I agree to abide by this waiver of responsibility and the Constitutions and By-Laws of the Richland County Agriculture Society and rules of the Department(s) I wish to enter, as printed in the premium book.

EXHIBITOR'S SIGNATURE _____ **2024**

PARENT/GUARDIAN'S SIGNATURE _____ **2024**